

Pumper, PUC

BODY

Pumper, PUC, Aluminum

CHASSIS

Enforcer Chassis, PUC

CHASSIS

AXLE, FRONT, CUSTOM

18,000 Lb TAK-4 Axle

AXLE, REAR

31,000 Lb Dana Axle

ENGINE

450 HP Cummins L9 Engine

TRANSMISSION

Allison 5th Gen, 3000 EVS P

BUMPER

19" Extended Painted Steel

CAB

7010 Enforcer Cab, PUC

BODY

WATER TANK

1000 Gallon Poly Water Tank

COMPT, PUMPER, REAR

33.50" FF RollUp Rear Compt w/Tailboard, PUC

COMPT, PUMPER, LEFT SIDE

189" RollUp Full Height & Depth Front & Rear, PUC

COMPT, PUMPER, RIGHT SIDE

189" RollUp Full Height & Depth Front & Rear, PUC

FIRE SUPPRESSION

PUMPHOUSE

Control Zone, PUC

PUMP

1500 GPM Pierce PUC

CROSSLAYS, 1.50"

(2) 1.50" Poly Trays, 200' of 1.75"

CROSSLAYS, 2.50"

(1) 2.50" Poly Tray, 200' of 2.50"

GENERATOR

Generator Not Required

Foam System

Husky 3 Single Agent Foam System

Foam Cell

30 Gallon Foam Cell, Not Reduced Water, PUC

Side Roll and Frontal Impact Protection

NOTE

DIMENSIONS SHOWN ARE APPROXIMATE AND ARE SUBJECT TO MINOR DEVIATIONS AS MAY OCCUR OR BE NECESSARY IN CONSTRUCTION. MINOR DETAILS NOT SHOWN.

- ONE 1.50" OUTLET WITH 2.00" PIPING AND SWIVEL LOCATED IN CENTER BUMPER TRAY
- SHORELINE RECEPTACLE WITH BLUE SEA SURE EJECT LOCATED ON DRIVER SIDE OF THE CAB
- AIR INLET WITH DISCONNECT COUPLING IN THE DRIVER SIDE STEPWELL
- BATTERY CHARGER LOCATED EMS CABINET
- BATTERY CHARGE INDICATOR LOCATED ON THE DRIVER SIDE SEAT RISER
- FOUR ADJUSTABLE SHELVES IN COMPARTMENTS PER SHOP ORDER
- FOUR FLOOR MOUNTED SLIDE-OUT TRAYS IN COMPARTMENT PER SHOP ORDER
- ONE ADJUSTABLE SLIDE-OUT TRAY LOCATED PER SHOP ORDER
- ONE TILTING/SLIDE-OUT TRAY LOCATED PER SHOP ORDER
- THREE SWING-OUT TOOLBOARDS LOCATED PER SHOP ORDER

- CTECH TWO DRAWER ASSEMBLY LOCATED PER SHOP ORDER
- ALUMINUM PEGBOARD LOCATED PER SHOP ORDER
- BOLT-IN PARTITIONS BETWEEN COMPARTMENTS LS1/B1 & RS1/B1
- ONE VERTICAL PARTITION LOCATED PER SHOP ORDER
- LITTLE GIANT LADDER MODEL 13 LOCATED PER SHOP ORDER
- HANNAY BOOSTER REEL MODEL EFG-4138-17-18 WITH CAPACITY FOR 100' OF 1.00" BOOSTER HOSE LOCATED IN COMPARTMENT B1
- TWO 120V DUPLEX RECEPTACLES LOCATED PER SHOP ORDER
- ONE ADJUSTABLE SHELF W/ SPECIAL SIDES LOCATED PER SHOP ORDER
- ONE ALUMINUM TOOLBOARD ADDED TO SLIDE-OUT TRAY LOCATED PER SHOP ORDER
- ONE 3/8" PLATE LOCATED PER SHOP ORDER

127.00
(10'-7")
APPROX
O.A.H.

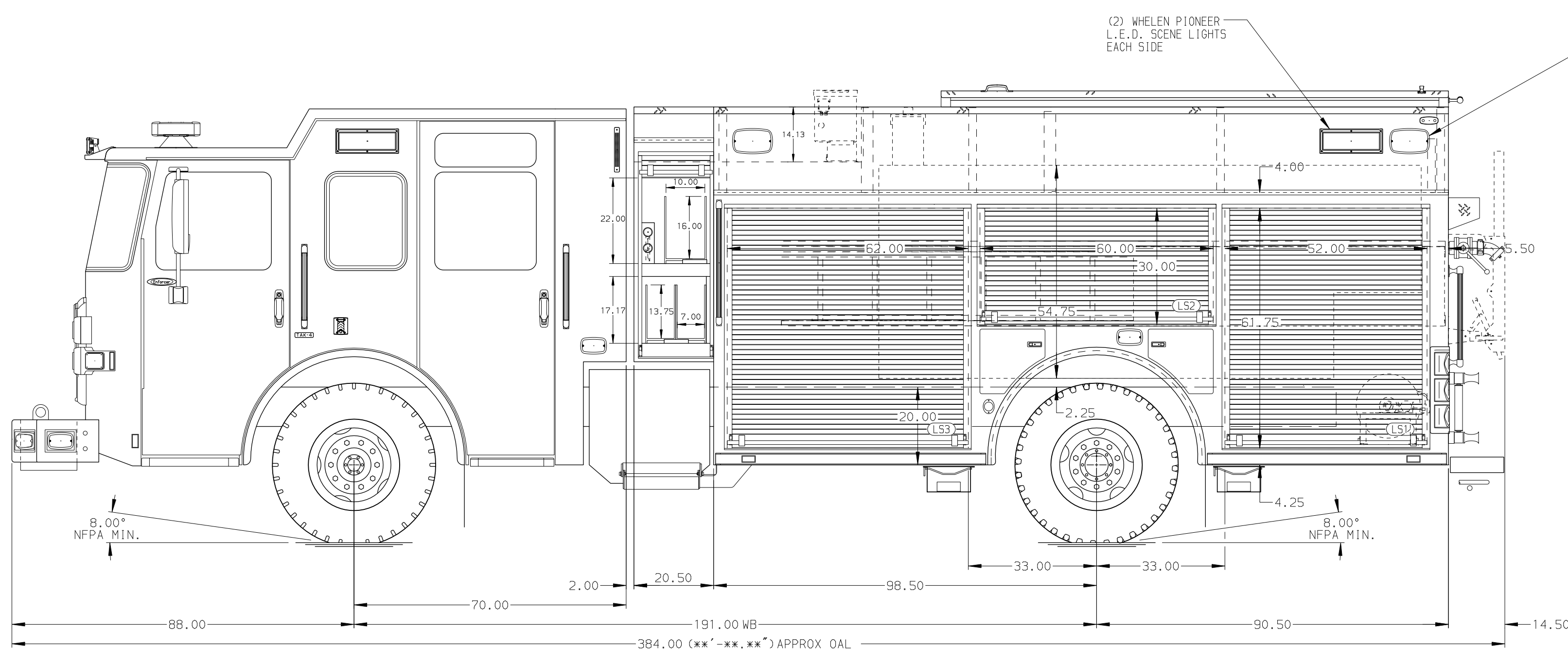
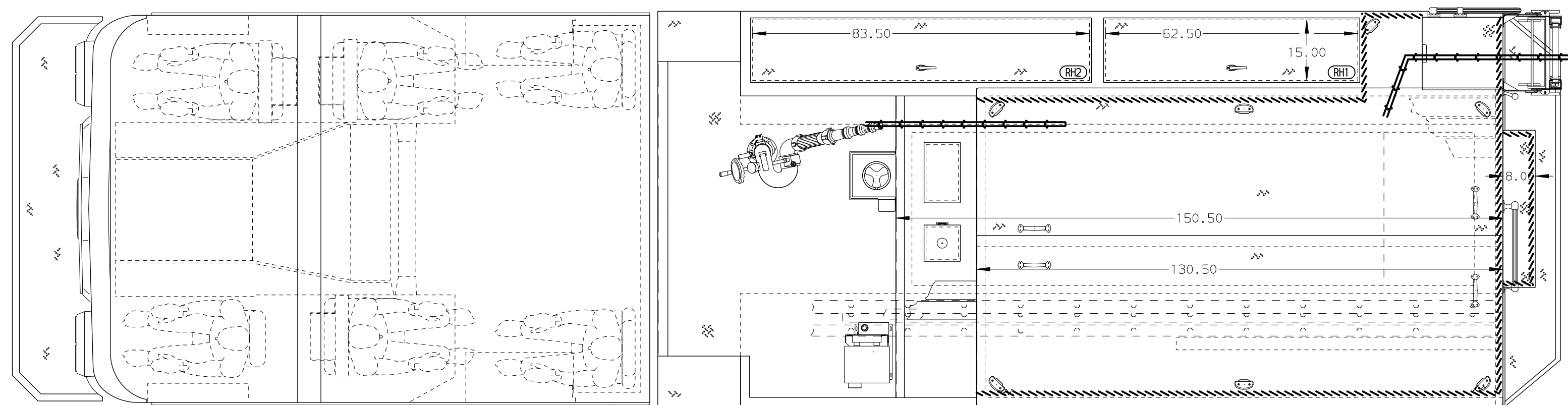
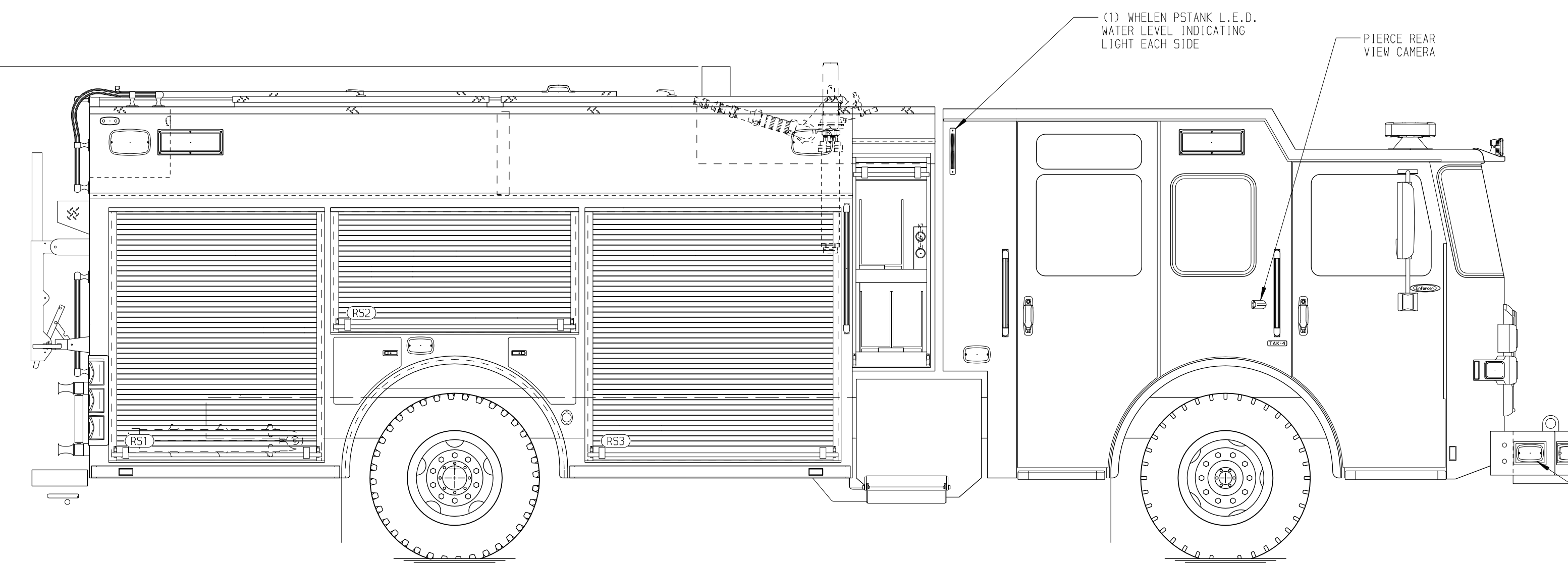

(1) WHELEN TALE5 L.E.D. TRAFFIC DIRECTING LIGHT

(1) WHELEN M9 L.E.D. WARNING LIGHT EACH SIDE

PIERCE REAR VIEW CAMERA (RECESSED)

COMPARTMENT FOR (2) PIKE POLES

(1) FOLDING LADDER DS LONG ITEM STORAGE P5

(2) WHELEN M9 L.E.D. WARNING LIGHTS

(1) 2.50" TANK FILL

STORAGE COMPARTMENT FOR DUD-SAFETY LADDERS:

(1) 24" 2-SEC 900A

(1) 14' ROOF 775A

(1) BACKBOARD (2' X 14' X 72")

(1) CUP SWITCH FOR REAR SCENE LIGHTS

(1) CUP SWITCH FOR HOSE BED LIGHTS

STOP-TAIL-BACK-UP & DIRECTIONAL L.E.D. LIGHTS IN A COMMON BEZEL

(2) WHELEN M9 L.E.D. WARNING LIGHTS

(1) 2.50" OUTLET

(2) WHELEN PIONEER L.E.D. SCENE LIGHTS

8.00" NFPA MIN.

22.00

10.00

16.00

62.00

60.00

52.00

54.75

51.75

20.00

2.25

4.25

8.00" NFPA MIN.

14.13

4.00

5.50

88.00

70.00

2.00

20.50

191.00 WB

98.50

33.00

33.00

90.50

14.50

384.00 (**'-**") APPROX OAL

HOSEBED CAPACITY

BED 1

250' OF 3.00" D.J. POLY HOSE

BED 2

1000' OF 5.00" D.J. POLY HOSE

BED 3

250' OF 3.00" D.J. POLY HOSE

(1) WHELEN TALE5 L.E.D. TRAFFIC DIRECTING LIGHT

(1) WHELEN M9 L.E.D. WARNING LIGHT EACH SIDE

PIERCE REAR VIEW CAMERA (RECESSED)

COMPARTMENT FOR (2) PIKE POLES

(1) FOLDING LADDER DS LONG ITEM STORAGE P5

(2) WHELEN M9 L.E.D. WARNING LIGHTS

(1) 2.50" TANK FILL

STORAGE COMPARTMENT FOR DUD-SAFETY LADDERS:

(1) 24" 2-SEC 900A

(1) 14' ROOF 775A

(1) BACKBOARD (2' X 14' X 72")

(1) CUP SWITCH FOR REAR SCENE LIGHTS

(1) CUP SWITCH FOR HOSE BED LIGHTS

STOP-TAIL-BACK-UP & DIRECTIONAL L.E.D. LIGHTS IN A COMMON BEZEL

(2) WHELEN M9 L.E.D. WARNING LIGHTS

(1) 2.50" OUTLET

(2) WHELEN PIONEER L.E.D. SCENE LIGHTS

8.00" NFPA MIN.

22.00

10.00

16.00

62.00

60.00

52.00

54.75

51.75

20.00

2.25

4.25

8.00" NFPA MIN.

14.13

4.00

5.50

88.00

70.00

2.00

20.50

191.00 WB

98.50

33.00

33.00

90.50

14.50

384.00 (**'-**") APPROX OAL

HOSEBED CAPACITY

BED 1

250' OF 3.00" D.J. POLY HOSE

BED 2

1000' OF 5.00" D.J. POLY HOSE

BED 3

250' OF 3.00" D.J. POLY HOSE

(2) HOSE BED DIVIDERS W/ HAND HOLD CUTOUPS

(1) WHELEN TALE5 L.E.D. TRAFFIC DIRECTING LIGHT

(1) WHELEN M9 L.E.D. WARNING LIGHT EACH SIDE

PIERCE REAR VIEW CAMERA (RECESSED)

COMPARTMENT FOR (2) PIKE POLES

(1) FOLDING LADDER DS LONG ITEM STORAGE P5

(2) WHELEN M9 L.E.D. WARNING LIGHTS

(1) 2.50" TANK FILL

STORAGE COMPARTMENT FOR DUD-SAFETY LADDERS:

(1) 24" 2-SEC 900A

(1) 14' ROOF 775A

(1) BACKBOARD (2' X 14' X 72")

(1) CUP SWITCH FOR REAR SCENE LIGHTS

(1) CUP SWITCH FOR HOSE BED LIGHTS

STOP-TAIL-BACK-UP & DIRECTIONAL L.E.D. LIGHTS IN A COMMON BEZEL

(2) WHELEN M9 L.E.D. WARNING LIGHTS

(1) 2.50" OUTLET

(2) WHELEN PIONEER L.E.D. SCENE LIGHTS

8.00" NFPA MIN.

22.00

10.00

16.00

62.00

60.00

52.00

54.75

51.75

20.00

2.25

4.25

8.00" NFPA MIN.

14.13

4.00

5.50

88.00

70.00

2.00

20.50

191.00 WB

98.50

33.00

33.00

90.50

14.50

384.00 (**'-**") APPROX OAL

		JOB NO.	33542
		SCALE	DATE
		1:24	
Pierce PUC Pumper Approval Drawing		DRAWN BY	25FEB19
FOR Lindale Fire Department		CHECKED BY	28FEB19
DWG NO. 33542AD		SHEET SIZE	SHEET NO.
		D	1 OF 1

REV	DATE	BY	CH	ENFORCER
10JUL19	COL	PPE		CHASSIS DATA
18JUN19	KLE	KW1		MAKE
08APR19	COL	PPE		PIERCE
14MAR19	COL	PPE		MODEL